

TSLH

DESMI Two-stage Horizontal Centrifugal Pump with high differential pressure pumps including a flow up to 48 m³/h and pressure up to 135 mLC at 60 Hz.

The TSLH pumps are two-stage, single-suction centrifugal pumps. Both vertical and horizontal installations are available. The suction port and discharge port are an inline or angular arrangement.

Two impellers in a tandem array achieve both high pressure and high efficiency. The main wet parts are casted, ensuring various pump materials are attainable.

Low pressure seal chamber extends the shaft seal life time. Innovative volute and impeller structure minimize the axial and radial force on shaft to enable steady running. Split casing in three parts allows overhauling of the rotation parts without disturbing pump casing or pipeline. Optimal flow passage to guarantee high efficiency achieved.

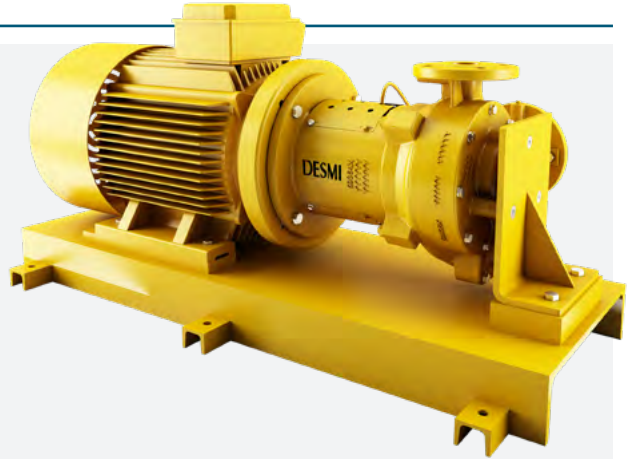

Concept Features:

- 3 positions availability for inline and angular port arrangement.
- Inlet and outlet in the same height, inline design for easy assembly.
- Longer mechanical seal life design, low pressure placing design.
- High pump efficiency - optimal transition flow passage design to realize minimum pressure loss.
- Longer pump life - innovative impeller design to balance the axial force on shaft.
- Longer pump life - innovative dual volutes design to balance the radial force on shaft.

Applications

- Boiler water supply
- Ballast water backflush
- Sprinkler
- Fire water jockey
- EGCS demist cleaning
- Industrial cleaning
- Water treatment and filtration
- Etc.

Norminal Diameter (DN)	40 & 50
Flow rate - 50 Hz	Up to 40 m ³ /h (180 US gpm)
Flow rate - 60 Hz	Up to 48 m ³ /h (210 US gpm)
Head	Up to 135 m (440 ft)
Pressure	Up to 16 bar (230 psi)
Temperature	Up to 140°C (284 °F)
Motor	Standard and Ex motor
VFD	Direct or Bulhead/Wall-mounted

DESMI

TSLH-50 Hz

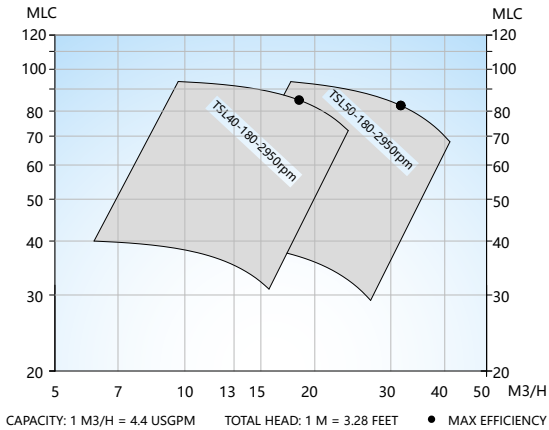

TSLH-60 Hz

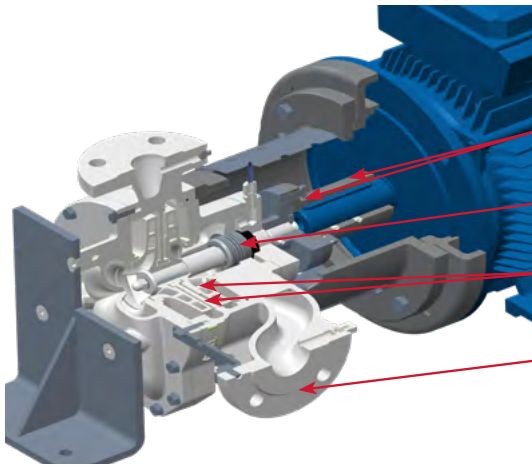
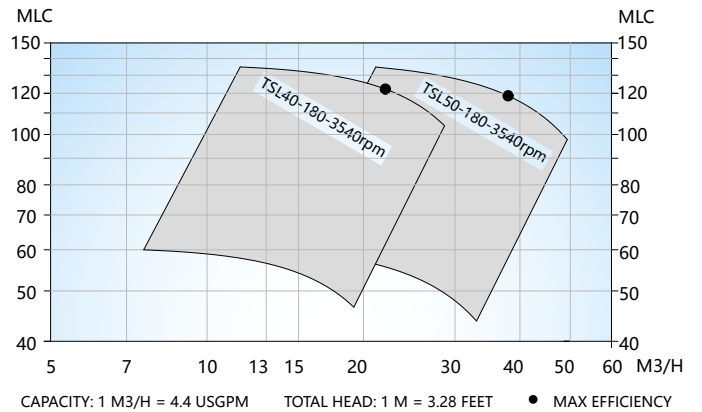

Overhaul rotation parts without disturbing pump casing or pipeline.

Low pressure seal chamber to ensure long shaft seal life.

Innovative impeller and volute design that minimize the axial and radial force on shaft, steady running.

Both inline and angular port arrangements are available, flexible installation.

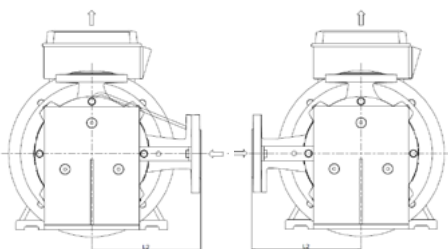
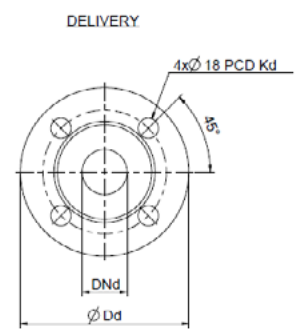
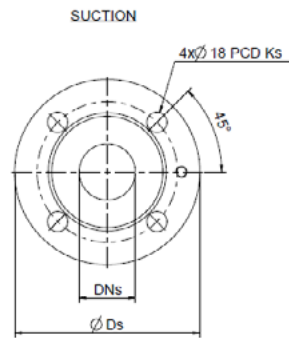
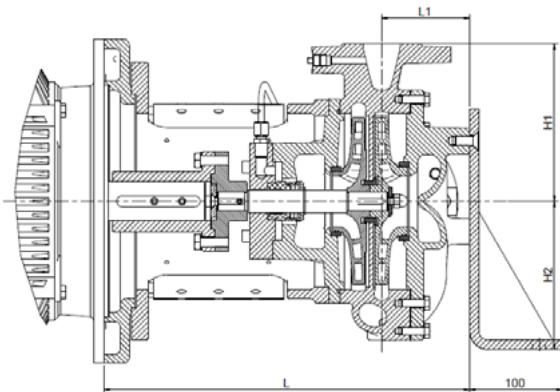

TSLH	Motor Size	L1	L2	L	H1	H2	DN _s	K _s	DN _d	D _s	K _s	DN _d	D _d	K _d
TSLH40-180	160	95	230	395	170	160	50	40	150	165	125	40	150	110
	132			365										
	100/112			344										
	90			344										
TSLH50-180	160	100	260	415	180	160	65	50	165	185	145	50	165	125
	132			385										
	100/112			364										
	90			364										